



## TENDER NOTIFICATION

The Head, CLPC, Sri Adichunchanagiri Shikshana Trust invites closed tenders from eligible tenderers or bonafide licensed manufacturer (OEM) or their authorized local supplier/ dealer/ distributor in the state of Karnataka for the **Procurement of**

- **Air Conditioner for BGSCET MBA, Mahalakshmi Puram, Bengaluru – 560086**
- **Radiology department at AHRC, ACU, BG Nagar, Mandya and**
- **Central Lab at AHRC, ACU, BG Nagar, Mandya - as per section I & II.**

01	Name of the work	Procurement of <ul style="list-style-type: none"><li>• Air Conditioner for BGSCET MBA, Mahalakshmi Puram, Bengaluru – 560086</li><li>• Radiology department at AHRC, ACU, BG Nagar, Mandya and</li><li>• Central Lab at AHRC, ACU, BG Nagar, Mandya</li></ul>
02	Last Date for Tender Submission	On or before 30.12.2024 before 5.30 PM

### Section-1

#### Instructions to Tenderers

- 1) The Tenderer shall submit the bids (Technical & Financial bids) through the mail id: **clpchead@bgscet.ac.in** on or before the last date of tender submission (for any or all list of items) on professional business letterheads only. The details to be printed on the letter head is as follows
  - i) Tender for Procurement of
    - **Air Conditioner for BGSCET MBA, Mahalakshmi Puram, Bengaluru – 560086**
    - **Radiology department at AHRC, ACU, BG Nagar, Mandya and**
    - **Central Lab at AHRC, ACU, BG Nagar, Mandya**
  - ii) Tender Reference number.....[Insert Number]
  - iii) Address to “The HEAD, CLPC, Sri Adichunchanagiri Shikshana Trust, BGSCET Campus, Mahalakshmi puram, Bengaluru – 560086”
  - iv) The tenderer shall submit the original documents to this office on the last day of submission for verification who prefers to submit the tender through Post can dispatch the same through Registered post / Speed post or Couriers as to reach the above address on or before the due date and time specified in the Tender Notice. Tenders received after the due date and time, for what so ever reasons will not be considered and the authority, Head of CLPC will not be liable or responsible for the same.
- 2) **Tender Currency:** Prices shall be quoted in Indian Rupees only.
- 3) **AMC/CMC (IF ANY)** is subject to the Sri Adichunchanagiri Shikshana trust's norms.
- 4) **Warranty:** 3 Years.
- 5) **Amendment of tender documents:** At any time prior to the deadline of submission of tenders the trust may, for no reason, whether as its own initiative or otherwise modify the tender documents by amendment. Sri Adichunchanagiri Shikshana Trust reserves all the rights to accept, reject, incorporate changes and re-tender without giving any reasons.



- 6) **Documents Comprising the Tender:** Shall attach Brochure, Certification of the product, Bank/account details, PAN, GSTIN, Good Standing Certificate and 02 years of ITR declaration inside the envelope and the company contact details with email id on the in the below mention format in annexure - 1.
- 7) **Tender Prices:** Prices indicated on the price schedule shall be entered separately I.e. the price of the goods, quoted (ex-works, ex-factory, ex-showroom, ex-warehouse, or off-the-shelf, as applicable), including all duties and sales and the other taxes already paid or payable. Any Indian duties, sales and other taxes which will be payable on the goods if the contract is awarded. Conditional tenders will not be considered. The bidder has to give the quotation in the below enclosed format in annexure - 2.
- 8) **Validity of the Bid:** 90 days from the last date of submission of bid.
- 9) **Corrupt or Fraudulent practices:** Sri Adichunchanagiri Shikshana Trust requires that the tenderers observe the highest standard of ethics during the procurement and execution of such contracts. In purchase of this policy:
  - a) Will reject a proposal for award if it determines the tenderer recommended for award has engaged in corrupt or fraudulent practices in competing for the contract in question;
  - b) Will declare a firm ineligible, either indefinitely or for the stated period of time, to be awarded a university contract if it any time determines that the firm has engaged in corrupt or fraudulent practices in competing for, or in executing, a trust contract.
- 10) **Process to be confidential:** Information relating to the examination, clarification, evaluation, and comparison of tenders and recommendations for the award of contract will not be disclosed to tenderers or any other persons not officially concerned with such process until the award to the successful tenderer has been announced. Any effort by a tenderer to influence the employer's processing of tenders or award decisions may result in rejection of his tender.
- 11) **Clarification of Tenders:** To assist in the examination, evaluation, and comparison of tenders the employer may, at his discretion, ask and tenderer for clarification of his tender, including breakdowns of unit rates. The request for clarification and the response shall be writing or by cable, but no change in the price or substance of the tender shall be sought, offered, or permitted except as required to confirm the correction of arithmetic errors discovered by the employers in the evaluation of the tenders.
- 12) **Delivery:** The successful BIDDER should commence the service as per the tender document/work or purchase order. For any queries or assistance, please write to [clphead@bgscet.ac.in](mailto:clphead@bgscet.ac.in) or telephone to +91- 9448270489.
- 13) **Penalty Clause:** Non-execution of supply order - for the reasons of failure to supply partially or completely within the stipulated time or any event of breach of contract. In case at any following stages
  - a) For the delayed supply (3 days of grace period) - 5% deduction
  - b) Quantity issues - 5 % deduction
  - c) Quality issues - 10% deduction



**Section-2**  
**Technical Specification**

**BGSCET - MBA**

**Inverter Air Conditioner**

SR NO.	DESCRIPTION	QTY	UNIT	Rate per Unit in Rs.	Amount in Rs.
1	3.5 TR Ceiling Mounted 4 Way Cassette Type Air conditioners	2	No's		
	<b>ANCILLARY WORKS</b>				
B	installation, Testing & Commissioning of Air conditioners				
i	3.5 TR Ceiling Mounted 4 Way Cassette Type Air conditioners	2	No's		
2	Refrigerant Piping for above air conditioners with Nitrile rubber insulation for Suction				
	& Liquid lines & Color code for Discharge lines				
ii	3.5 TR Ceiling Mounted 4 Way Cassette Type Air conditioners	40	Rmt		
3	Electrical Cabling for-	44	Rmt		
4	Mounting arranged for condensing units with MS Fabricated dual cote painting for				
	non rusting				
iii	3.5 TR Ceiling Mounted 4 Way Cassette Type Air conditioners	2	No's		
5	HDPE CPVC Drain Piping for water outlet of all the machine with necessary slope	40	Rmt		

*[Handwritten Signature]*



	and clamping.				
6	Refrigerant R32 gas charging	0	kg		
7	Voltage Stabilizer for Split Units(V GUARD)	0	No's		
8	Scuff holding Charges for copper piping support for external pipes	1	lot		
9	3" PVC Covering for External Pipes	0	Rmt		
<b>Grand Total in Rs.</b>					
<b>GST in Rs.</b>					
<b>Grand Total (Inclusive of GST in Rs.)</b>					

SCHEDULE OF QUANTITIES AND RATES FOR THE - HVAC WORK'S							
ADICHUNCHANAGIRI HOSPITAL AND RESEARCH CENTER B G NAGARA							
PART B : HVAC WORK'S CENTRAL LAB							
SCHEDULE OF QUANTITIES AND RATES FOR THE - HVAC WORKS							
SI No	DESCRIPTION	UNIT	QTY	UNIT RATE IN Rs.		AMOUNT in Rs.	
				MATERIAL	LABOUR	MATERIAL	LABOUR
1	DOUBLE SKIN CABINET AIR FAN -EXHAUST AIR FAN						
	Double skin type floor mounted units complete with double skin (23±2 mm) insulated with CFC free polyurethane foam (PUF) panels of 42 Kg/cum density. Sandwiched between 0.6 mm thick G.I. Sheets. Outer skin shall be pre plasticized G.I. sheet and internal skin shall be powder coated G.I. sheet. The unit shall be provided with forward curved blower, IE-2 Motor, drive set & guard, spring isolator to						





	avoid transmission of vibration, etc. The motor shall be with IP21 protection, class 'F' insulation.						
	Make : Krugar / Nicotra						
1.1	1500 CFM- 35 mm wc . ESP	Nos.	2				
2	GI DUCT						
	Supply, Fabrication, installation and testing of Aluminium sheet metal ducts (Machine made) in accordance with the approved shop drawings complete with all accessories like vanes, flanges, suspension rods , anchor bolts, GI bolts & nuts, canvas connections , duct dampers & splitter dampers etc., and as required by the specifications. The zinc coating for the sheets to be at 120gsm. All exaust work						
2.1	24G. Ducting	Sqmt.	80				
3	DIFFUSER						
	The Diffuser shall be of removable core type and constructed with high grade aluminum extruded alloy and with powder coated finish (without collar damper). All diffusers shall have a continuous square neck of minimum 32mm height suitable for fixing spill air box.						
3.1	Neck size: 375 x 375mm., Outer size: 595x595mm.	No's	12				
4	LOUVERS - Al.						
	High grade aluminum extruded Louvers for Fresh air intake & Exhaust air exit at outer wall. The louver shall be of powder coated finish.	Sqmt.	1				

*Handwritten signature*



5	FLEXIBLE DUCT-UNINSULATED						
	The supply & installation of flexible duct inner core should be made of triple lamination of Aluminum Foil, Polyester & Metalized polyester film permanently bonded to a coated spring steel wire helix, complete with connecting rings, duct supports etc. as per standards and specification						
5.1	200 mm Dia	Rmt	12				
6	BUTTERFLY DAMPER						
	Supply, Installation, Testing & Commissioning of Spigot & Butterfly Dampers of the following sizes. The Butterfly damper should be constructed with not less than 0.8mm thick galvanized steel sheet, with single flap, necessary stopper, flanges for fastening on to the duct surface and with grooves for clamping the flexible ducts securely.						
6.1	200 mm dia	No's	12				
7	SPILL AIR PLENUM BOX.						
	The supply & installation of FACTORY FABRICATED spill air boxes made out of 0.8mm thick GI sheet with necessary spigot connection for fixing flexible duct and suitable collar for connecting to various neck diffuser / slot diffuser. The box should be internally insulated with 6mm thick nitrile rubber of class 'O' material. The box size shall be as mentioned below.						
7.1	Box size of 375x375x300 mm and equivalent required rectangular sizes.	No's	12				
8	POWER CABLES						

*[Handwritten signature]*



	Supply, laying testing and commissioning of following sizes of XLPE insulated PVC sheathed armoured aluminium conductor cable					
8.1	2 Core 2.5 Sqmm.	Rmts.	10			
8.2	4 Core 4 Sqmm.	Rmts.	35			
9	DX TYPE INVERTER CASSETTE AC CASSETTE UNIT					
	wall mounted unit wall mounted type indoor unit with multi speedfan cooling coil, remotesensor,thermostat, washable filters,auto swing in boath directions, low noise fan, inbuilt drain pump, drainfan,stylish design, complete with refrigerent valve set,electronic expansion valve, and cordles remote controal, power wiring from nearest socket to indoorunit.controal wiring between indoor to out door unit etc, as per the tender drawing and specification. drain pump shall be consider. make blue star					
9.1	3.0 tr inverter cassette AC	NOS	3			
10	supply and installtion of outdoor stand	NOS	3			
11	supply and installtion of refrigerent copper pipe	Rmt	40			
12	Suplly and installtion of 25MM PVC drain pipe	Rmt	25			
13	PVC FREASH AIR PIPE					
	supply and installtion of PVC freash air pipe including fitting					
13.1	140mm	Rmt	30			
13.2	110mm	Rmt	R/O			
<b>SUB-TOTAL BASIC VALUE</b>						
<b>TOTAL BASIC VALUE</b>						



**SCHEDULE OF QUANTITIES AND RATES FOR THE - HVAC WORK'S**

**AHRC HOSPITAL B G NAGARA**

**PART B : HVAC WORK'S FOR EXISTING RADIOLOGY EXTENSION HVAC WORK**

**SCHEDULE OF QUANTITIES AND RATES FOR THE - RADIOLOGY EXTENSION**

Sl No	DESCRIPTION	UNIT	QTY	UNIT RATE		AMOUNT	
				MATERIAL	LABOUR	MATERIAL	LABOUR
1	OUT DOOR UNIT - VRF						
	Supply, Installation, Testing & Commissioning of Outdoor condensing unit comprising of Hermetic SCROLL compressor's, Heat Exchanger, propeller / axial fans, refrigerant circuit, Safety Devices & Oil Recovery System, operating on R410a refrigerant gas.						
	Microprocessor based control panel, able to integrate with BMS of any make seamlessly. Necessary hardware / software must be included.						
	First charge of Refrigerant Gas and oil charge.						
	Compressor shall be hermetic scroll compressor and shall be equipped with inverter controller of Insulated Gate Bipolar Transistor (IGBT) type to be efficient & quiet. Outdoor unit shall have step less capacity control with ALL INVERTER Compressors.						
	Minimum two or more compressors per Out door module						
	Condenser : Air-cooled condenser, shall be constructed with copper tubes mechanically bonded to aluminium fins to form a cross fin coil. Aluminium fins shall be coated with anti-corrosion coating.						
	Refrigerant Circuit shall include an accumulator, liquid and gas shut off valves and a solenoid						

*Handwritten signature*





	valves.						
	Outdoor unit shall include the following safety devices: High pressure switch, Low pressure switch, Fan motor safety thermostat, Inverter overload protector, Over Current relay, Fusible plugs, Fuses, Spring type vibration isolators etc., Outdoor unit supporting arrangement, foundation block, supporting MS platform, Painting with two coats of black paint.						
	Unit shall be equipped with an oil recovery system to ensure stable operation with long refrigerant piping.						
	Unit shall be equipped with power fluctuation safety devices to address frequent power fluctuations.						
	Complete electrical power wiring of Aluminum & control wiring of copper required from indoor and outdoor units. Earthing of the complete system with 8 G G.I wire.						
	Electrical Panel will be complete with necessary starters, fuses, switches, timers, over-load relays, contactors, push button and indicating lamps, single phasing PREVENTOR etc.,						
	All outdoors units shall be mounted on MS angle base frame structure duly black painted with synthetic epoxy paint.						
	Frame structure shall be mounted on MS plate & serrated rubber pads.						
	Complete clamping and saddling of cabling work and refrigerant piping, covered with PVC conduiting.						
	Cooling only application						
	Power wiring from nearest electrical panel (Provided by other agency) to Outdoor						

*Handwritten signature*



	unit running in 32mm dia GI Conduit.						
	Local Transportation, Insurance, Loading, Unloading, Freight charges from ICD to site, Lifting of ODU to Terrace level and Indoor unit to respective floors, Levelling charges, etc.,						
	Port Clearing Charges if any						
	Installation, Pressure testing, Commissioning and Handing Over of total VRF system. Includes Indoor & Outdoor unit installation, gas leak test and charging of refrigerant gas etc.,						
	Necessary Hardware & Software required for BMS integration						
	REFRIGERANT GAS R410A ONLY						
	High COP machines						
	Outdoor unit should be able to withstand voltage fluctuation of +/-10%						
	First charge of refrigerant gas						
	Actual Cooling Capacity at Designed indoor & Out door conditions						
	Ambient Condition: For Summer						
	Out door unit must be selected for 56 deg C DB in Summer						
	Inside Design Condition:						
	23 deg C ± 1 deg C & ≤ 60 % RH						
	Make : Blue Star / Mitsubishi						
1.1	12 HP (existing units)	Nos.	1				
2	AIR COOLED DX CONDENSING UNITS						
	Supply, Installation, Testing and Commissioning of DX air cooled Condensing unit, each complete with Scroll						

*[Handwritten Signature]*



	Compressors, condenser fans, R410a refrigerant Gas, microprocessor based control panel, all necessary controls, valves and fittings, etc., Unit shall be suitable for 415 ± 10% Volts, 50 cycles / second, 3 phase AC supply.						
	Actual capacity at Design operating conditions:						
	Make : Blue Star / Mitsubishi/dikan						
2.1	11.0 TR	Nos.	1				
3	VRF Indoor - Ceiling Mounted 4 Way Cassette Type Unit.						
	Supply, Installation, Testing and Commissioning of Ceiling mounted 4way-Cassette unit, Cassette indoor unit shall have necessary filters, cooling coil, corded remote control with thermostat, electronic expansion valve, fittings, supporting arrangement, fan, fan motor, Condensate drain pump, decorative panels etc., as per Tender drawing and Specification.						
	Unit shall have provision for outdoor fresh air duct connection.						
	3 speed adjustment						
	Noise Level < 32 dBA @ 1.0M from Mouth Outlet						
	Panel Size <= 36"x36"						
a	Large Type Unit 3'X3'						
3.1	2.8 TR Large Cassette Indoor Unit with Remote(existing units)	Nos.	2				
3.2	2.3 TR Large Cassette Indoor Unit with Remote(existing units)	Nos.	1				
3.3	2.0 TR Large Cassette Indoor Unit with Remote(existing units)	Nos.	1				
4	REFNET JOINTS						
	Supply and Installation of Necessary Ref joints, valves as per the schematic	Nos.	3				



	drawing.make bluestar						
5	<b>REFRIGERANT PIPING</b>						
	Refrigerant piping liquid and suction lines between the VRF aircooled outdoor units and indoor units. Piping shall be carried out with 18 G Hard drawn copper pipes with soldered / brazed socket fittings. Both suction and liquid lines shall be insulated with closed cell nitrile rubber insulation & exposed piping shall be covered with two layers of Fibre Glass cloth and coated with two layers of shield coating. Make: Rajco / Mexflow / Prasmani( suction + liquid pipe consider)						
	34.9 mm with 13mm thick tubular insulation	Rmt	R/O				
	28.6mm with 13mm thick tubular insulation	Rmt	75				
	22.2mm with 13mm thick tubular insulation	Rmt	10				
	19.1mm with 13mm thick tubular insulation	Rmt	15				
	15.9mm with 13mm thick tubular insulation	Rmt	50				
	12.7mm with 13mm thick tubular insulation	Rmt	50				
	9.5 mm with 13mm thick tubular insulation	Rmt	20				
	6.4 mm with 13mm thick tubular insulation	Rmt	20				
6	<b>COMMUNICATION CABLE</b>						
	Communication cabling of 2C x 1.5 Sqmm from Indoor to outdoor units, external wiring to be run in 1" dia GI conduit and inside wiring shall run in 1" dia PVC conduit	Rmt	80				
7	<b>POWER CABLE</b>						
	Electrical Power cable between the indoor unit and power socket with 2	Rmt	15				



	Core, 2.5 sqmm / as required, unshielded copper cable, with 1 no. plug top for each IDU.						
8	Supply and installation of UPVC drain pipe insulated with 6mm/9mm nitrile rubber insulation including elbows, connectors, U traps, Y-connections and flexible tubing for all indoor units to the nearest toilet drain /pantry drain/ HVAC shaft available as per site conditions and as per directions of the Architect/Consultant/ site engineer. The quote should inclusive of all Hardware necessary to secure the pipes.						
8.1	25mm dia with 6mm thick nitrile rubber insulation	Rmt	20				
8.2	32mm dia with 6mm thick nitrile rubber insulation	Rmt	40				
9	Referigerant Gass Charging R-410A	Kg	25				
10	Referigerant Gass Charging R-22	Kg	15				
11	11 TR ductable machine dismantling and re-installtion work	NOS	1				
13	Pressuse Testing , Vacuming , Commissioning and Handing over of the System. 2 Set's of drawing and handing over book.	Lot	1				
14	OUTDOOR UNIT STAND						
	Supply & Installtion of MS outdoor units stand suitable for VRF Outdoor unit floor mounted type units painted with two coats of non corrosive paint (black) & necessary supporting arrangements.	Nos.	1				



15	G.S.S DUCTING as per SMACNA Standards. FOR OT CORRIDOR						
	All ducting shall be of factory fabricated completely finished and transported to site in a boxed form (including the duct flange and the VAV transition pieces and Z pieces if any). GS sheet shall be Class VIII - with zinc coating of 120 gm / sqmt surface area. TDF type flanges with neoprene rubber gaskets of thickness to match the dimensions of the ducts shall be used for connecting two ducts. The cost of the duct shall include the threaded rod supports, angle flanges, anchor fastners, hot dipped galvanized bolts and nuts etc., The Duct to be manufactured and assembled as per SMACNA standard for Class-500pascals.						
15.1	24G. Ducting	Sqmt.	55				
16	LOUVERS - Al.						
	High grade aluminum extruded Louvers for Fresh air intake & Exhaust air exit at outer wall. The louver shall be of powder coated finish.	Sqmt.	1				
17	FLEXIBLE DUCT- UNINSULATED						
	The supply & installation of flexible duct inner core should be made of triple lamination of Aluminum Foil, Polyester & Metalized polyester film permanently bonded to a coated spring steel wire helix, complete with connecting rings, duct supports etc. as per standards and specification						

*Handwritten signature*





17.1	150mm Dia	Rmt	15				
18	BUTTERFLY DAMPER						
	Supply, Installation, Testing & Commissioning of Spigot & Butterfly Dampers of the following sizes. The Butterfly damper should be constructed with not less than 0.8mm thick galvanized steel sheet, with single flap, necessary stopper, flanges for fastening on to the duct surface and with grooves for clamping the flexible ducts securely.						
18.1	150 mm dia	No's	12				
19	EXHAUST VALVES						
	Exhaust valves constructed from Extruded Aluminum powder coated finish with control damper.						
19.1	Neck size: 150mm Dia	Nos.	20				
20	POWER CABLES						
	Supply, laying testing and commissioning of following sizes of XLPE insulated PVC sheathed armoured aluminium conductor cable						
20.1	4 Core 10 Sqmm.	Rmts.	25				
20.2	4 Core 6 Sqmm.	Rmts.	20				
20.3	4 Core 4 Sqmm.	Rmts.	10				
21	supply and installtion of balancing and commissioning of cabinet fan for following capacities complete with eletric motor suitable for operation on 220V 10% 50hz 1 phase AC supply fitted with speed regulatir, 15 amp plug and wiring between the fan and the socket mounting framews, louvers and bied screen						
21.1	2100 cfm cabinet inline	NOS	1				



	fan@25MM esp					
21.1	Miscellaneous work	LOT	1			
<b>SUB-TOTAL BASIC VALUE</b>						
<b>TOTAL BASIC VALUE</b>						

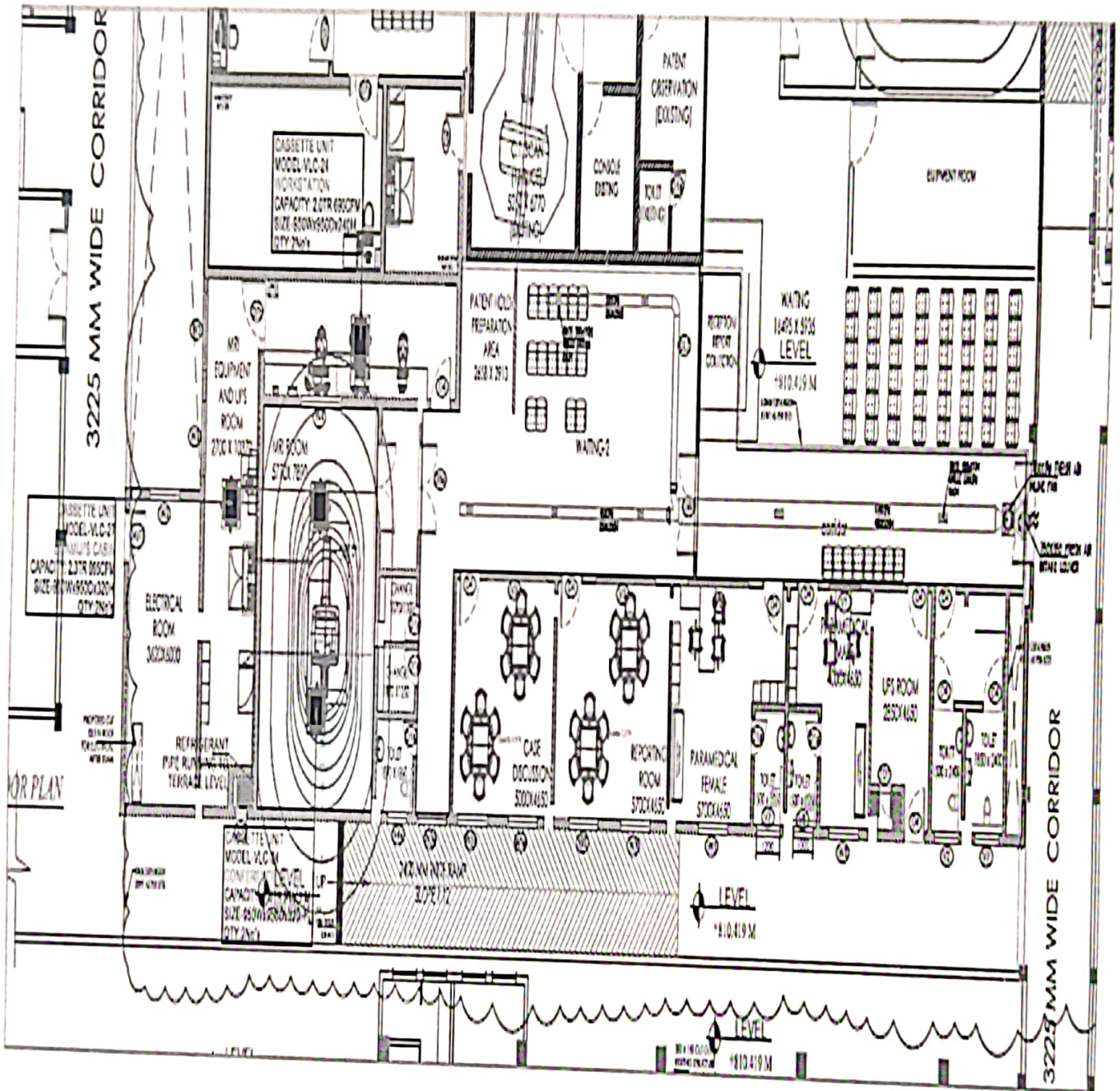

*Handwritten signature*





## Annexure - 1

### PARTICULARS OF THE BIDDER

Sr. No	Description	Details (to be filled by the responder to the Bid)
1	Name of the company	
2	Official address	
3	Phone No. And Fax No.	
4	Corporate Headquarters Address	
5	Phone No. And Fax No.	
6	Web Site Address	
7	Details of Company's Registration (Please enclose copy of the company registration document)	
8	Name of Registration Authority	
9	Registration Number and Year of Registration	
10	ISO certifications and its validity	
11	GST registration No.	
12	Permanent Account Number (PAN)	
13	Company's Revenue for last 3 years (Year wise)	
14	Company's net worth for the last year	
15	Bank Details (Name, Account no., Branch, IFSC, MICR)	

*[Handwritten Signature]*



Sri Adichunchanagiri  
Shikshana Trust @  
Mahalakshmi Puram,  
Bengaluru-560086

## Annexure – 2

The Bidder has to quote the rate in the Item Data available online with this bid. Details to be filled up for price bid are as below:

**The price shall be inclusive of all taxes (inclusive of GST) under the relevant Laws of India.**

SL. No	Particular	Amount In Rs. (Inclusive of All the taxes)
1	Total Cost for the Procurement of Air Conditioner for BGSCET-MBA, Mahalakshmi Puram, Bengaluru – 560086.	
2	Radiology department at AHRC, ACU, BG Nagar, Mandya	
3	Central Lab at AHRC, ACU, BG Nagar, Mandya	
Total in Rs and in words –		

  
**HEAD, CLPC**  
**SRI ADICHUNCHANAGIRI**  
**SHIKSHANA TRUST**  
**BANGALORE - 560086**

